

CN1

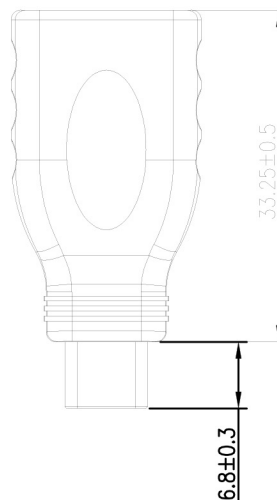

CN2

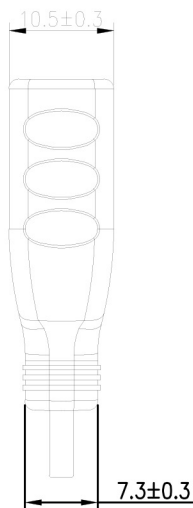
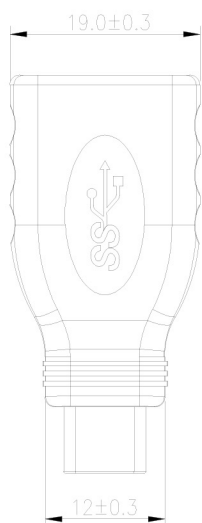
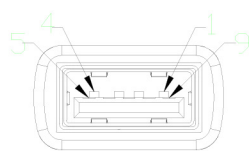
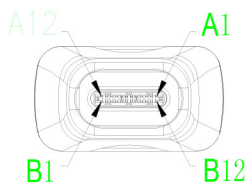

NOTE:

1. TESTING CONDITIONS:
 - 1.1 100% TEST FOR OPEN AND SHORT
 - 1.2 CONDUCTOR RESISTANCE: 3Ω
 - 1.3 INSULATION RESISTANCE: 10MΩ/DC300/0.01S
2. REAL MACHINE USE DATA:
 - 2.1 DATA READING / WRITE SPEED: 5Gbps MAX.
 - 2.2 CURRENT: 3A MAX.
 - 2.3 VOLTAGE: 5V
3. SUPPORT OTG
4. ALL COMPONENTS ARE RoHS/REACH COMPLIANT.

PIN OUT

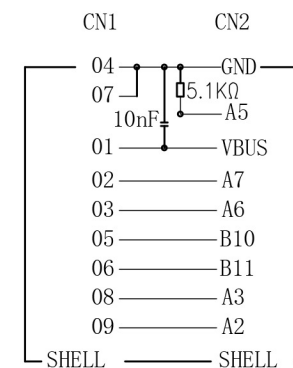

VBUS=A4-A9-B4-B9
GND=A1-A12-B1-B12-SHELL

⑤	MOLDED	OVER MOLDING: BLACK PVC	AR	G
④	MOLDED	INNER MOLDING: PE	AR	G
③	PCB	PCB: R 5.1KΩ, C 10nF	1	PCS
②	CONNECTOR	USB3.0 A FEMALE: GOLD PLATED CONTACTS, NICKEL PLATED SHELL, BLUE INSULATION	1	PCS
①	CONNECTOR	TYPE C MALE: GOLD PLATED CONTACTS, NICKEL PLATED SHELL, BLACK INSULATION	1	PCS
NO.	MATERIAL	DESCRIPTION	QTY.	UNIT

Ltemref	Quantity	Title/Name, designation, material, dimension etc			Article No./Reference	
Designed by	Checked by	Approved by - date	File name	Date	Scale	FREE
ANGLE:			ADAPTOR: TYPE CM TO 3.0 AF, 5G/OTG, BLACK			
UNIT:MM			26-0430	Edition	Sheet	
			1	1/1		